

## PUNTO

1.6W 500mA 3V (2.5-4)V DC  
3000K 30° CRI 90

42686 Bianco (White) / Bianco (White)  
42687 Bianco (White) / Silver  
42688 Bianco (White) / Oro (Gold)  
42689 Bianco (White) / Nero (Black)

42690 Nero (Black) / Nero (Black)  
42691 Nero (Black) / Silver  
42692 Nero (Black) / Oro (Gold)  
42693 Nero (Black) / Bianco (White)

## PUNTO L

6W 350mA 18V (16-20)V DC  
3000K 30° CRI 90

42694 Bianco (White) / Bianco (White)  
42695 Bianco (White) / Silver  
42696 Bianco (White) / Oro (Gold)  
42697 Bianco (White) / Nero (Black)

42698 Nero (Black) / Nero (Black)  
42699 Nero (Black) / Silver  
42700 Nero (Black) / Oro (Gold)  
42701 Nero (Black) / Bianco (White)

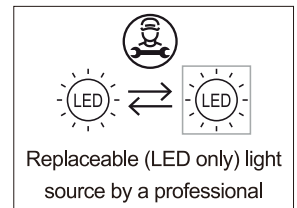

**PUNTO**

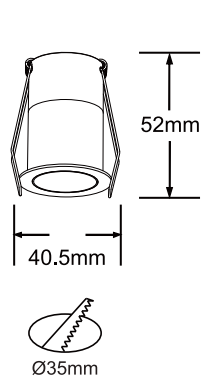

**PUNTO L**

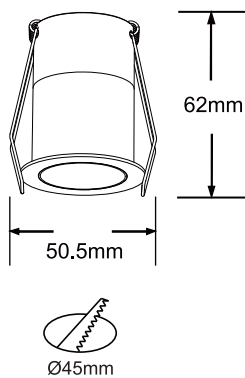

1.

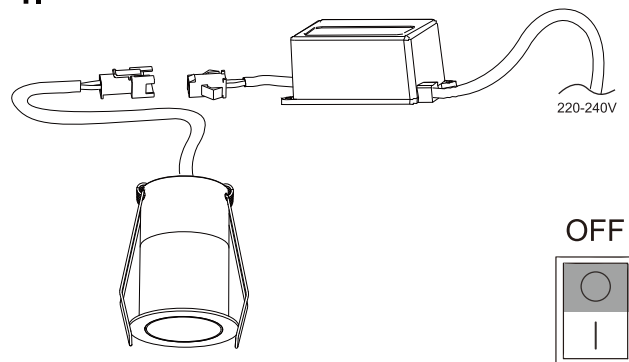

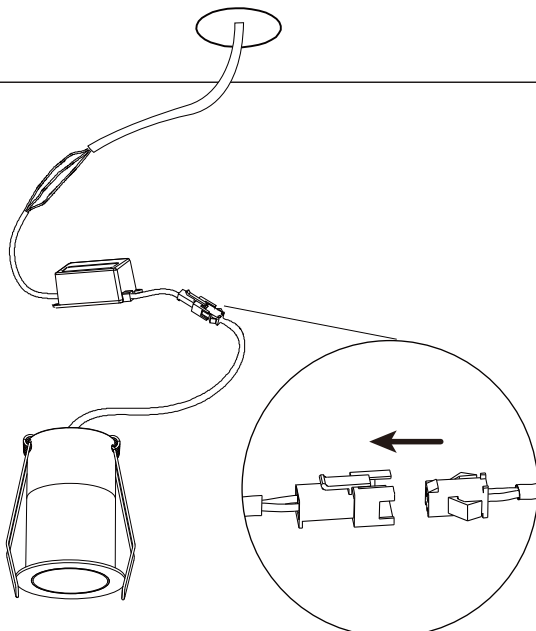

2.

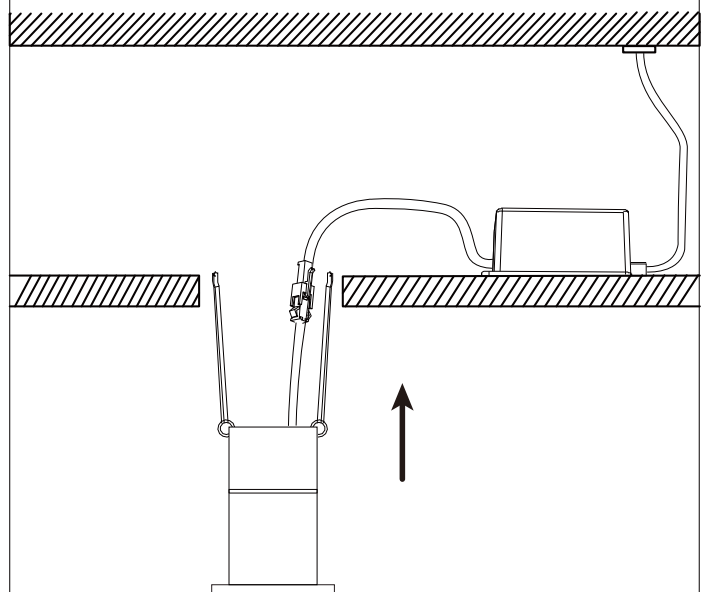

3.

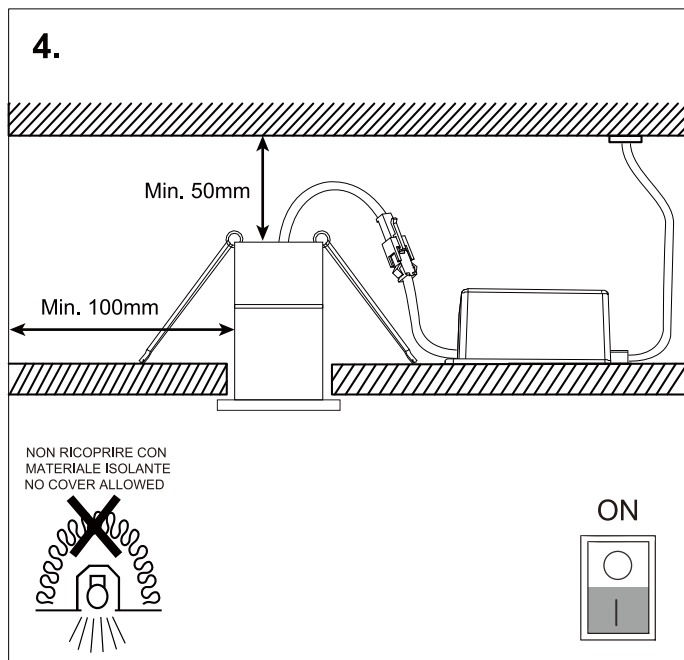



1. Togliere tensione prima dell'installazione o qualsiasi manutenzione.
2. L'installazione e la manutenzione devono essere affidate a personale qualificato e devono essere eseguite conformemente alle prescrizioni delle vigenti normative impianti.
3. La fonte luminosa di questo apparecchio non pu essere sostituita; quanto la fonte luminosa raggiunge il fine vita deve essere sostituito l'apparecchio completo.
4. Il prodotto in Classe III è fornito senza alimentatore indipendente PUNTO (500mA 3V (2.5-4) V DC) o PUNTO L (350mA 18V (16-20) V DC).
5. Questo prodotto contiene una fonte luminosa di Classe Energetica G.
6. Il simbolo  riportato sull'apparecchio indica che il prodotto deve essere smaltito in modo differenziato dai rifiuti urbani

1. Disconnect the power supply before installation or any maintenance work.
2. Installation and maintenance must be carried by qualified personnel and according to the current Directives on electrical systems.
3. The light source of this luminaire is not replaceable; when the light source reaches its end of life the whole luminaire shall be replaced.
4. The product in Class III is provided without driver PUNTO (500mA 3V (2.5-4) V DC) or PUNTO L (350mA 18V (16-20) V DC).
5. This product contains light source of energy efficiency class G.

6. This symbol  shown on the device indicates that the product must be disposed of in a way which differs from the standard urban rubbish



LOGICA è un marchio



MARINO CRISTAL SPA  
Via Guardia del Consiglio, 29/30  
47899 Serravalle Repubblica di San Marino  
el. 0549 901188 - Fax 0549 900612  
[www.marinocristal.com](http://www.marinocristal.com)

